

1. Draw your closet walls in the grid below. Grid is scaled 1 square equals 1'x1'foot

2. Add Storage Cabinets and/or Shelf and Rods

- Use the scaled rectangles below draw in the location of your cabinets. Rectangles represent an overhead view of the units and how much space they will take up.
- Write in the rectangle whether you want a **Single Hang SH, Double Hang DH, Shelf Cabinet SHF, Drawer/Door Cabinet DWR.**
- Note the width of the cabinet (18", 24", 30", 36") or shelf/rod (up to 47.25 W or up to 96" W) if doing basic shelving. Add 1.5" to width of cabinets for exterior dimensions.
- Indicate Full or Half Cabinet. Full cabinets have solid backs and can include drawers, doors, shelves, hanging. Half Cabinets can only be DH or SH.

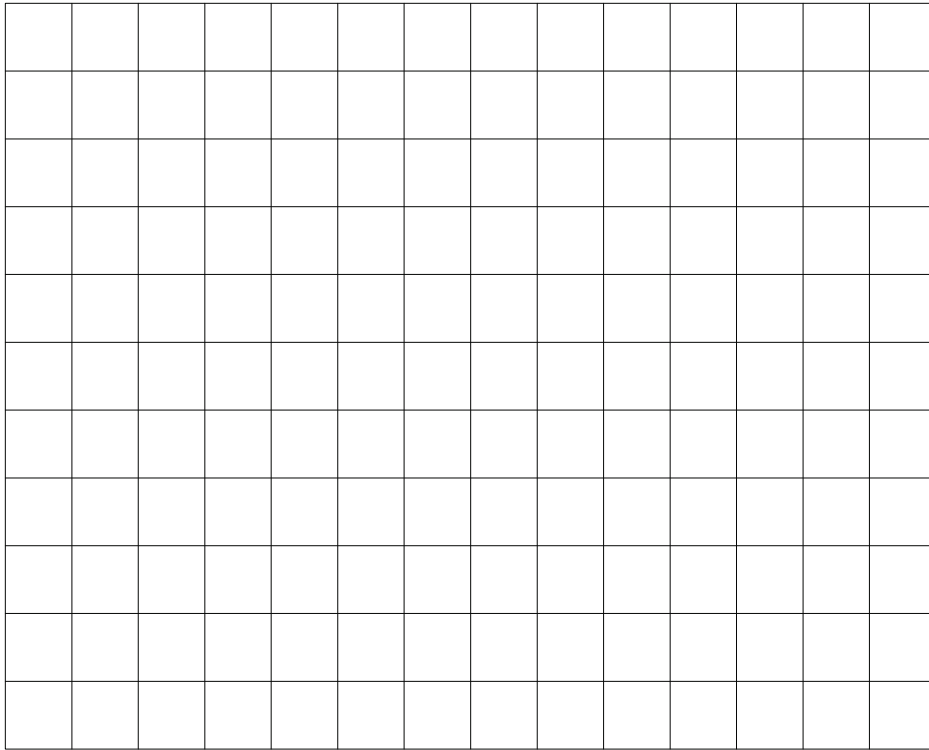

Grid Square = 1'x1'
Units below Drawn to scale with tower widths listed.

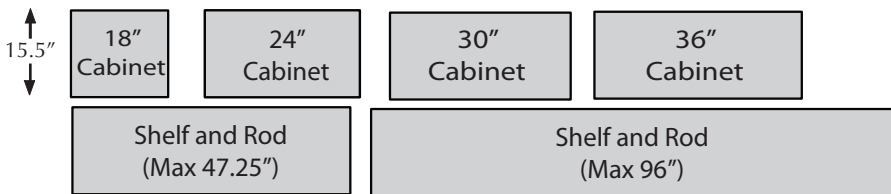

Contact Info

Name _____

Phone _____

Email _____

4. Select your finish, options, then scan and send to woodtrac@sauder.com or fax to 888-761-8303 for a quote.

- Cherry
- Espresso
- White
- Salt Oak

Planning Tips:

- In a corner leave 24" of space between a unit and an adjoining wall so there is enough space to hang clothes or open doors/drawers.
- Be sure units don't obstruct closet entry doors
- Use Shelf Cabinets for shoe storage.
- Have at least 50% hanging storage for an average closet.
- Avg closets needs 18-36" of single Hang

Example

